

全国免费服务热线
Nationwide toll free **800-8015-777**

先进技术 精湛工艺

浙江富士美电梯有限公司
ZHEJIANG FUJIM ELEVATOR CO.,LTD.

地址: 浙江湖州南太湖高新技术产业园区梅家漾路55号 邮编(Zip Code): 313000
Address: No. 55 Zhejiang Huzhou South Tai Lake High-Tech Industrial Park, Waterfront Road Huong
总机(Switchboard): +86-572-2792898 传真(Fax): +86-572-2792860
国内业务部(Domestic Business Unit): +86-572-2792863 2757771 2757772 2757773
国际业务部(International Business): +86-572-2799091 2799092
网址(Web): <http://www.fujimdt.com>
E-mail: FUJIMDT@163.com



扫描二维码
关注富士美电梯门户网站

本书为一般信息类出版物,我们保留随时更改产品设计和说明的权利。本书的任何字句,无论其字面意思或含义,对于任何产品及该产品的用途和质量,或者任何购销合同条款的表述与更改均不承担任何责任。
This publication is for general informational purposes and we reserve the right at any time to alter product design and specification. No statement contains should be construed as a warranty or condition, express or implied, as to any product, its fitness for any particular purpose or quality or any modifications or representation of the terms of any purchase agreement.

FUJIM
Elevator

VILLA ELEVATOR
别墅电梯

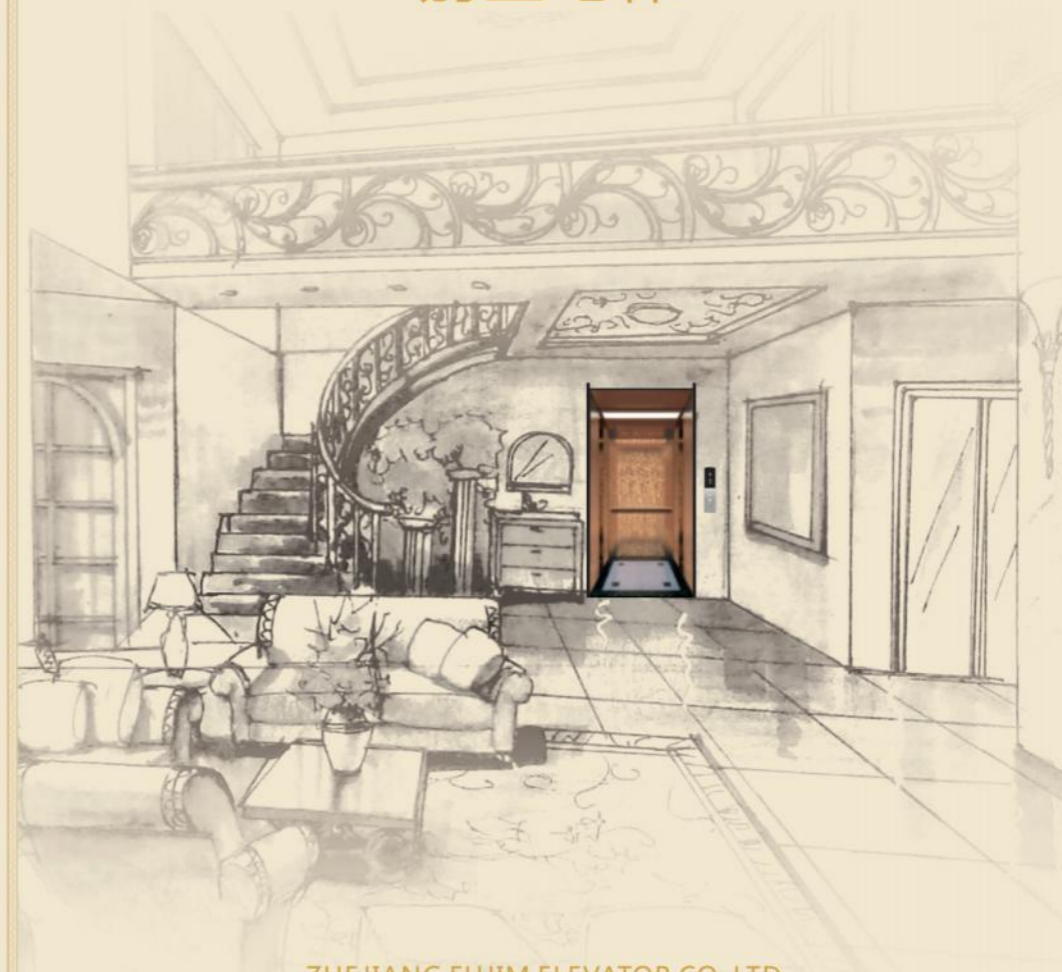

ZHEJIANG FUJIM ELEVATOR CO.,LTD.
浙江富士美电梯有限公司

企业文化

愿 景：以卓越产品和服务成为客户的首选品牌

精 神：激情、挑战、合作、创新

价 值 观：诚信、敬业、知识、团队精神

核心理念：客户至上、高效执行、持续改善、合作共赢

corporate culture

Vision: to be the first choice for customers with excellent products and services.

Spirit: passion, challenge, cooperation, innovation

Values: integrity, professionalism, knowledge, team spirit

Core concept: customer first, efficient implementation, continuous improvement, cooperation and win-win



富士美电梯公司总部位于浙江湖州南太湖高新技术产业园区，地处杭嘉湖平原腹地，北环风景秀丽的太湖之滨，近邻上海、杭州、苏州等繁华城市，高铁、高速互通，交通便捷。富士美电梯是一家实力雄厚、技术领先的高端电梯产品制造和服务公司。目前生产基地年产能2万台以上，拥有电梯研发试验中心，专业从事于电梯产品研发设计、制造、安装、改造、维修保养全方位服务。公司持有制造、安装双A级许可，通过了多项管理体系认证和产品认证，还获得了很多荣誉证书。

富士美“FUJIM”品牌一直以走高品质、高性能的产品路线，为客户打造高性价比的电梯精品。公司拥有一批行业精英和专业研发人才，有着先进的技术力量，获得了众多创新和专利成果。

富士美电梯转型推动“互联网+制造”，走向智能制造“工业4.0”，成为智能工厂和智能生产。采用国外最先进的电梯制造工艺标准和严谨的管理体系，机械加工应用精湛的全数控机械加工技术和机器人流水线制作，控制系统采用微电脑自动化控制技术，制造出安全舒适、节能环保、超群性能的电梯产品，实现高品质的FUJIM牌电梯。电梯品种齐全，有乘客电梯、无机房客梯、观光电梯、病床电梯、载货电梯、无机房货梯、汽车电梯、杂物电梯、自动扶梯、自动人行道、家用电梯等全系列产品。

公司已在国内各大城市设立了子公司、代表处、分支机构及售后服务中心。产品还远销国外多个国家，为全球客户提供产品全方位服务，形成完善、高效的服务网络。公司以高品质、精细服务、诚信承诺的经营理念去完成每一个项目。“先进技术、精湛工艺；诚信合作，和谐共赢”是富士美企业的核心，“完美品质、服务至上、客户满意”是富士美对客户的永远承诺。

FUJIM elevator company headquarters is located in Nantaihu high-tech industrial park, Huzhou, Zhejiang, where is in the hinterland of Hangjiahu plain, around by Taihu lake that has beautiful scenery. It is near from Shanghai, Hangzhou and Suzhou etc. High-speed train and highway supplied convenient transportation. FUJIM elevator is a company which is with strength, and advanced technology in high-end elevator products manufacturing and service. At present, annual production capacity reached more than 20000 sets. The company have research & test center that specially take up the services of researching, designing, manufacturing, installation, renovating, repair and maintenance. And with A class license on manufacturing and installation. Meanwhile the company have passed the various management system and product certificates, also reward many honorary certificates.

"FUJIM" brand stick high quality and function line to manufacture high cost performance elevator for user. The company has a number of industry elite and professional research people, with advanced technology, obtained many achievements and patents.

FUJIM elevator promote the transformation of "Internet plus beauty", to intelligent manufacturing industry 4, become intelligent and smart production plant. Adopts the most advanced foreign elevator manufacturing standards and strict management system, consummate machining application of CNC machining technology and robot assembly line production, the control system by microcomputer automatic control technology, to create a safe and comfortable, environmental protection and energy saving, superior performance of the elevator products, to achieve high quality FUJIM brand elevator. With great variety products, such as Passenger elevator, MRL elevator, Observation elevator, Bed elevator, Freight elevator, MRL freight elevator, Car elevator, dumbwaiter, escalator, moving walk, home elevator etc.

The company has set up subsidiaries in domestic cities, representative offices, branches and after-sales service center. Products are exported to overseas, supply products and all-round services for global users, forming perfect and efficient service network. Company with high quality, fine service and the management idea of good faith commitment to do each project. "Advanced technology, superb craft, honesty cooperation and harmony win-win are core of enterprise culture". "Perfect quality, service first, customer satisfaction" are the commitment from FUJIM to user forever.



领先技术 智能生活

Leading technology
Intelligent life

节能永磁同步无齿轮曳引机 Energy saving permanent magnet synchronous gearless traction machine

采用永磁同步无齿轮曳引机，突破传统设计，无需励磁，启动电流小，传动效率高，结构更合理。
节能环保，节能效果达30%以上，低噪音低震动，无油污染，运行宁静。

Adopt the permanent magnet synchronous gearless machine. breaks through the traditional design, without excitation, start small current, high transmission efficiency to make the structure more reasonable. Energy saving and environmental protection, energy-saving effect is more than 30%, low noise and low vibration, no oil pollution, running quiet.

先进的钢带曳引机

Advanced steel traction machine

专为别墅电梯而设计的钢带曳引机与传统无齿曳引机相比，运行更舒适，噪音低，顶层高度及底坑深度更小。

Designed for the villa elevator belt traction machine with traditional non gear traction machine compared, more comfortable operation, low noise, top height and bottom hole smaller depth.



舒适 Comfortable 节能 Energy-saving 灵活 Flexible 可靠 Reliable 高效 Highly effective

复合钢带——革命性的创新

Composite steel belt – revolutionary innovation

- ◆聚氨酯材料层，无需润滑，重量轻，震动幅度低。
- ◆寿命是传统钢丝绳的2~3倍。
- ◆易弯曲，增大与驱动轮接触面积，安全系数高。

- ◆The polyurethane material layer, no lubrication, light weight, low vibration amplitude.
- ◆The service life is 2~3 times of traditional wire rope.
- ◆Easy to bend, increase with the driving wheel contact area, high safety factor.



复合钢带
Composite steel belt

VS

传统钢丝绳
Traditional wire rope



钢带断丝智能检测技术

Intelligent detection technology of steel strip broken wire

High efficiency permanent magnet frequency door machine

高效永磁变频门机

富士美门机主要技术指标和安全性能都经过权威认证，确保电梯的安全稳定。采用最新的门驱动系统和闭环矢量控制，结构紧凑，节能环保，运用可靠，噪音低等特点。

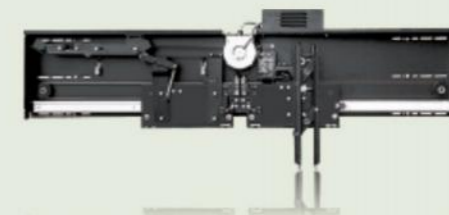

Main technical index and safety performance of FUJIMI door machine have passed authoritative attestation to ensure the security and stability of the lift. Using the latest door drive system and closed-loop vector control, compact structure, energy conservation, environmental protection, the use of reliable, low noise characteristics.

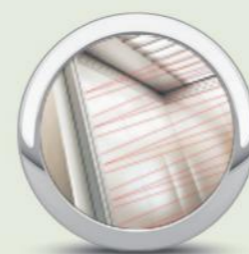

光幕门保护

Screen door protection

利用光幕保护系统，在电梯门口形成光束安全网，对于任何进入其探测区的人或物体能做出灵敏的反应，确保进出安全。

For any passengers into the detection zone or objects can make quick response, ensuring access to safe use of screen protection system, forming a safety net in the elevator door.



停电应急疏散装置

Emergency evacuation device

当电梯正常运行中突然断电急停时，该装置会迅速动作，驱动电梯低速运行至平层位置，平层后自动开门疏散乘客。

When the elevator power off suddenly and emergency stop while normal running, the device will quickly start work, drive the elevator to run into the level position, then open the door to evacuate passengers.



远程监控系统

Remote monitoring system

通过有线或无线通讯模块，在远程监控中心对电梯运行状况和电梯内乘客情况进行实时监控，使故障在发生前即排除，确保乘客安全。

Through wired or wireless communication module, in the remote monitoring center on the elevator running status and the situation of the elevator passengers real-time monitoring, so that the failure occurred before the exclusion, to ensure the safety of passengers.



无线电话

wireless telephone

无需任何施工铺架线、抗干扰能力强、音质清晰、无线呼叫覆盖半径大、智能化程度高、使用方便、安装简单等特性。

There is no need for any construction laying line, strong anti-interference ability, clear sound, wireless call coverage radius, high intelligent degree, convenient and simple installation characteristics.

性能卓越 非凡品质 畅享生活

Excellence performance
Extraordinary quality enjoy life

龙门轿架，更加平稳耐用

电梯轿厢采用最先进可靠的龙门轿架结构，即能增加轿厢稳定性、舒适度，同时也保证电梯在平衡的状态下运行，减少系统摩擦阻力，增大电梯部件寿命。龙门架式结构，对重位置可以左、右、后多方位安放，使得客户井道更合理布置，优化电梯轿厢规格和开门尺寸，显的更美观舒适。

Gantry type car frame, more stable equilibrium

Elevator car adopts the most advanced and reliable structure of gantry type car frame, which can increase the stability of the car, comfort, while also ensure that the elevator in a state of balance running, reduce system friction resistance, increase the life of the elevator parts. Gantry type car frame structure, the weight position can be left, right, after a multi position, make the customer well way more reasonable arrangement, optimize the elevator car specifications and door size, significantly more beautiful and comfortable.

背包架二代

在第一代背包架结构上优化，改变悬挂设计，采用中心悬挂，良好的解决了背包架的偏载问题，又可以实现完美的直角或者三面开门。

Backpack rack two generation

Optimization of the first generation backpack rack structure, change suspension design, central suspension way will solve the problem of the unbalance loading, and can achieve the perfect right angle or the three side door.

220V/380V别墅专用主机--节能新家电

常规电压，超小功率，超低能耗，实际耗电量等同于家用冰箱，运行功率小于一台微波炉，灵巧轻便，且无油污，无噪音，成为专属于您的节能新家电。

220V/380V Villa Dedicated Main Engine-- A New Energy-Saving Household Electrical Appliance

With conventional voltage, ultra-low power and ultra-low power, its actual power consumption is equivalent to household refrigerator, its operating power is less than a microwave. Being smart, portable, and oil-free and noise-free, it will become your new energy-saving household electrical appliance.



专属定制

Exclusive custom

根据客户的建筑楼宇、个人品味、特殊需求度身定制的全套解决方案。从装潢格调到功能配置，专业为您提供高度匹配的别墅电梯。

Construction of buildings according to the customer's personal taste, the special needs of the full range of tailor-made solutions. From decorating style to the functional configuration, to provide you with highly professional match villa elevator.

智能控制

intelligent control

为充分优化高端电梯的服务效能，富士美别墅电梯采用全电脑智能型控制系统，实现多微机、模块化、网络化控制等智能管理，让瞬息万变的运行状况尽在掌握。

In order to fully optimize the service performance of high-end lift, FUJIM villa elevator with full computer intelligent control system, multi-computer, modular, network control and other intelligent management, so that changing the operating conditions under control.

一体化井架

Integrated derrick

优越的一体化井架，安装方便快捷，美观豪华，分观光型和封闭型、半封闭型。井架材料客户可按装修风格选铝型材或钢型材。自由适应各类加装或改装的室内室外布局结构，施工周期短，快速无污染地为您的私宅服务，不打扰更贴心。

Superior integrated derrick, convenient and quick installation, beautiful and luxurious, sightseeing and closed, semi closed type. Derrick material customers can choose according to the decoration style aluminum or steel profiles. Freedom to adapt to all kinds of indoor and outdoor installation or modification of the layout of the structure, the construction period is short, fast and pollution-free service for your private home, do not disturb and more intimate.

人性化的开门式 满足您的需求

Humane door opening mode meets your require

富士美别墅电梯，采用多种开门方式提供用户选择，无论从设计上还是使用上为业主提供更多的选择和满足。

FUJIM villa elevator, use a variety of open the door way to provide the user choice, whether by design or use for the owners to provide more choice and satisfaction.



中分式 center-opening 旁开式 side-opening 手拉门 manually operated door

曳引式别墅电梯

Traction type Villa elevator

富士美曳引式别墅电梯采用高集成智能型控制系统，制动平稳、噪音低；轿厢设计灵活多样，可与不同风格的室内家装融为一体。不仅提升了建筑物的形象，更为居家主人创造出舒适亮丽的乘坐空间。

FUJIM Traction machine room villa elevator applies high integrated intellectual control system with smooth brake, low noise, flexible and diverse car design. It can combine with different styles of indoor decoration. It enhances the building image. Furthermore, it provides the owners with a bright and comfortable travel space.



曳引式别墅电梯的特点

Traction villa elevator characteristics

- ◆ 无需传统机房：节省建筑成本
- ◆ 可根据房屋结构开门需求采用背包架式和龙门架式电梯结构
- ◆ VVVF驱动技术：别墅电梯专用微机板控制，平稳舒适
- ◆ 专用曳引机机架：固定于导轨，建筑物可不承受力
- ◆ 主机：采用220V单相电源。普通家用电，无需另外申请工业电源
- ◆ 自动专用门机：变频节能，安全可靠
- ◆ UPS（后备电源）在停电时可以应急放人
- ◆ 直拨外线电话，紧急情况下，可以打给任何人
- ◆ 运行时总额定功率1.5KW（其中驱动系统1.1KW），比商用小电梯省电80%

- ◆ It needs no traditional machine room. It saves the building cost.
- ◆ It applies rucksack style and gantry style elevator structure according to door opening requirements of the housing structure.
- ◆ VVVF drive technology: Villa elevator special-purpose micro-computer control is smooth and comfortable.
- ◆ Special-purpose traction machine rack is fixed in guiderail. The building needs no bearing of any outer force.
- ◆ Host: It applies 220V single-phase power supply of ordinary family use. It needs no application for industrial power supply.
- ◆ Automatic special-purpose door machine: Variable frequency energy-saving, safe and reliable
- ◆ UPS (spare mains) can emergently release the passengers in power failure.
- ◆ Direct dialing of external line: Under emergency conditions, you can call anybody you want.
- ◆ In the operation, total rated power is 1.5KW including 1.1 KW for drive system. It saves 80% of electricity than that of a commercial use small elevator.



强制式别墅电梯

Forced type Villa elevator

富士美强制式别墅电梯，采用卷筒式强制驱动永磁同步无齿轮曳引机，包括永磁同步电动机、卷筒、编码器和起限制卷筒转动作用的电磁制动器，用链或钢丝绳悬吊的非摩擦方式驱动，专为私人家庭用户设计，为您缔造高尚生活空间，打理休闲私人时间，其以简约明快的装潢基调，安全实用的设计理念而独树一帜，您一经选择，必将感受到实用性、艺术性、时代性融为一体的全新体验。特别适用于电梯井道小的别墅电梯。

FUJIM forcibly villa elevators, use the roll forcibly driven permanent magnet synchronous gearless machine comprising a permanent magnet synchronous motor, reel, reel encoder and the limiting effect of rotating electromagnetic brake, with a chain or rope hanging non-friction manner crane driver, designed for private home users, you create the noble living space, personal care and leisure time, its brightly decorated in a minimalist tone, safe and practical design concepts and unique, you are a chosen, will feel to practical, artistic, times integration of new experience. Especially suitable for small villa elevator shaft elevator.



强制式别墅电梯的特点

Forced villa elevator characteristics

当控制面板输入信号，控制系统接收指令，电机通电转动带动卷筒旋转，继而转动钢丝绳，钢丝绳带动轿厢沿刚性导轨做直接运动，强行将轿厢进行提升和下降，钢丝绳一端连接在卷筒上，一端直接连在轿厢上，因此没有对重，不是靠摩擦力提升载重，而是靠机械力强行拉动，这是与曳引式电梯的最大区别。

Input signal when the control panel, control system to receive instruction, electric motor rotating drum rotates, and then turn the wire rope, wire rope drive the car along the guide rail directly exercise rigidity, forced the capsules for lifting and lowering, the wire rope end connection on the drum, even on the capsules directly at one end, so there is no weight, not by the friction load, but by mechanical force to pull, it is the biggest difference with traction type elevator.



别墅电梯轿厢装潢

Villa elevator car decoration



FJMQ-502 选配 Optional



吊 顶：镜面不锈钢框架，亚克力透光板
轿 壁：发纹不锈钢，镜面拉丝
扶 手：不锈钢单管扶手
地 板：PVC(可选大理石)

Ceiling: Mirror stainless steel, Acrylic transparent board
Car wall: Hairline stainless steel, Mirror drawing
Handrail: Titanium and stainless steel tube
Floor: PVC (Optional marble)

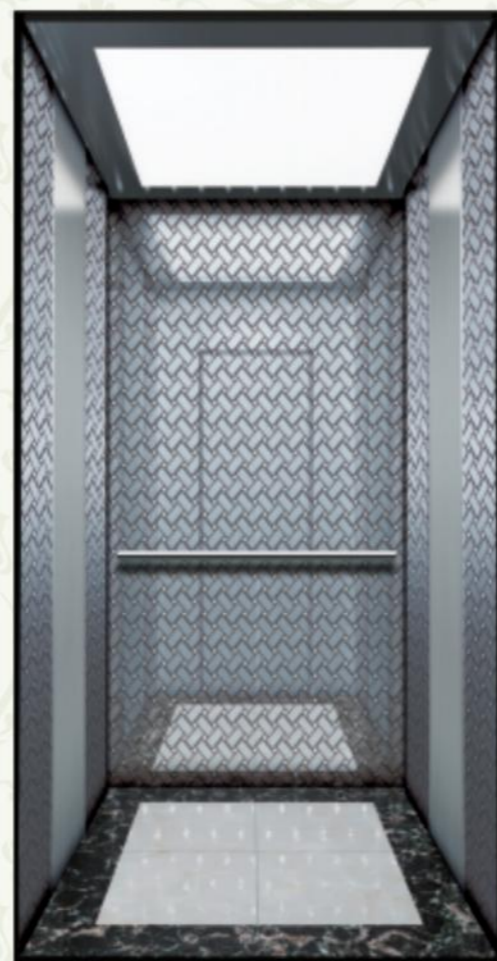

FJMQ-501 选配 Optional



吊 顶：镜面不锈钢框架，亚克力顶板
轿 壁：发纹不锈钢，镜面，压花
扶 手：不锈钢单管扶手
地 板：PVC(可选大理石)

Ceiling: Mirror stainless steel, Acrylic roof
Car wall: Stainless steel hairline, Mirror, embossing
Handrail: Titanium and stainless steel tube
Floor: PVC (Optional marble)



FJMQ-504 选配 Optional



吊 顶：镜面不锈钢加有机灯
轿 壁：镜面、蚀刻、发纹、浮雕
地 板：PVC(可选大理石)

Ceiling: Mirror stainless steel plus organic light
Car wall: Mirror, etching, hair pattern, relief
Floor: PVC (Optional marble)



FJMQ-503 选配 Optional



吊 顶：发纹不锈钢框架，亚克力灯饰
轿 壁：本色压花，镜面
扶 手：不锈钢单管扶手
地 板：PVC(可选大理石)

Ceiling: Stainless steel frame, Acrylic lighting
Car wall: Color embossed, Mirror
Handrail: Titanium and stainless steel tube
Floor: PVC (Optional marble)

注：图片系电脑绘制，可能与实际图有不同，以实物为准。
Note: pictures have been drawn by computer. It might be slightly different from actual colors. Please take real product as criterion.

注：图片系电脑绘制，可能与实际图有不同，以实物为准。
Note: pictures have been drawn by computer. It might be slightly different from actual colors. Please take real product as criterion.

别墅电梯轿厢装潢

Villa elevator car decoration



FJMQ-506 选配 Optional

吊 顶：镜面不锈钢框架，亚克力透光板
轿 壁：发纹，镜面不锈钢
地 板：PVC(可选大理石)

Ceiling: Mirror stainless steel, Acrylic transparent board

Car wall: hair pattern, Mirror stainless steel

Floor: PVC (Optional marble)



FJMQ-505 选配 Optional

吊 顶：镜面不锈钢加有机灯
轿 壁：镜面，蚀刻，发纹
扶 手：不锈钢单管扶手
地 板：PVC(可选大理石)

Ceiling: Mirror stainless steel plus organic light

Car wall: Mirror, etching, hair pattern

Handrail: Round stainless steel handrail

Floor: PVC (Optional marble)

注：图片系电脑绘制，可能与实际图有不同，以实物为准。
Note: pictures have been drawn by computer. It might be slightly different from actual colors. Please take real product as criterion.



FJMQ-508 选配 Optional

吊 顶：钛金不锈钢，亚克力灯饰
轿 壁：钛金，蚀刻不锈钢，镜面不锈钢
地 板：PVC(可选大理石)

Ceiling: Titanium stainless steel, acrylic lighting

Car wall: Titanium, etched stainless steel, mirror stainless steel

Floor: PVC (Optional marble)



FJMQ-507 选配 Optional

吊 顶：镜面不锈钢框架、LED灯
轿 壁：透明玻璃
扶 手：不锈钢单管
地 板：PVC(可选大理石)

Ceiling: Mirror stainless steel, LED light

Car walls: Transparent glass

Handrail: Stainless steel tube

Floor: PVC (Optional marble)



注：图片系电脑绘制，可能与实际图有不同，以实物为准。
Note: pictures have been drawn by computer. It might be slightly different from actual colors. Please take real product as criterion.

别墅电梯轿厢装潢

Villa elevator car decoration



FJMQ-510 选配 Optional



吊 顶：镜面/古咖不锈钢框架，LED灯
轿 壁：压花/古咖，镜面/古咖
扶 手：古咖不锈钢单管
地 板：PVC(可选大理石)

Ceiling: Mirror / ancient coffee stainless steel frame, LED light
Car wall: Embossed / ancient coffee, ancient mirror / coffee
Handrail: Ancient coffee stainless steel tube
Floor: PVC (Optional marble)



FJMQ-509 选配 Optional



吊顶：玫瑰金发纹不锈钢框架，LED灯
轿壁：玫瑰金压纹，镜面，发纹
扶手：玫瑰金不锈钢单管
地板：PVC(可选大理石)

Ceiling: Rose gold hair grain stainless steel frame, LED light
Car wall: Rose gold embossing, mirror, hairline
Handrail: Rose gold stainless steel tube
Floor: PVC (Optional marble)

注：图片系电脑绘制，可能与实际图有不同，以实物为准。
Note: pictures have been drawn by computer. It might be slightly different from actual colors. Please take real product as criterion.



FJMQ-512 选配 Optional



吊 顶：不锈钢镜面板框架，影像平顶
轿 壁：浮雕大师，镜面，蚀刻，钛金，钛黑横发纹
扶 手：钛金不锈钢单管
地 板：PVC(可选大理石)

Ceiling : Stainless steel mirror frame, image flat top
Car wall : Relief master, mirror, etching, titanium, titanium black cross hair pattern
Handrail: Titanium and stainless steel tube
Floor : PVC (Optional marble)

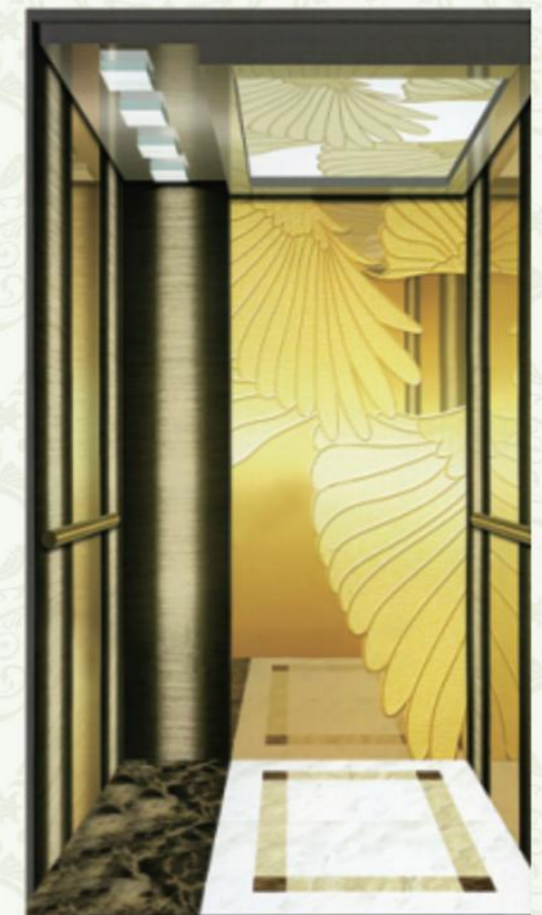

FJMQ-511 选配 Optional



吊 顶：发纹不锈钢/古铜、LED灯
轿 壁：哑光青古铜蚀刻，发纹不锈钢/古铜
扶 手：古铜不锈钢单管
地 板：PVC(可选大理石)

Ceiling: Hairline stainless steel/bronze, LED light
Car walls: Matte green bronze etching, Hairline stainless steel/bronze
Handrail: Bronze stainless steel tube
Floor: PVC (Optional marble)

注：图片系电脑绘制，可能与实际图有不同，以实物为准。
Note: pictures have been drawn by computer. It might be slightly different from actual colors. Please take real product as criterion.

别墅电梯轿厢装潢

Villa elevator car decoration



FJMQ-514 选配 Optional



吊顶：钛金镜面不锈钢，亚克力，LED灯

轿壁：钛金镜面蚀刻、发纹

地板：PVC(可选大理石)

Ceiling: Titanium gold mirror frame, acrylic, LED light

Car wall: Titanium mirror etching, hairline

Floor: PVC (Optional marble)



FJMQ-513 选配 Optional



吊顶：钛金镜面不锈钢，亚克力，LED灯

轿壁：钛金镜面蚀刻、发纹

扶手：钛金不锈钢单管

地板：PVC(可选大理石)

Ceiling: Titanium gold mirror frame, acrylic, LED light

Car wall: Titanium mirror etching, hairline

Handrail: Titanium and stainless steel tube

Floor: PVC (Optional marble)



FJMQ-516 选配 Optional



吊顶：木质烤漆框架，镜面不锈钢

轿壁：烤漆木板，贴墙纸装饰

地板：PVC(可选大理石)

Ceiling: Paint wooden frame, mirror

stainless steel

Car wall: Paint wood, wallpaper decoration

Floor: PVC (Optional marble)



FJMQ-515 选配 Optional



吊顶：木饰面板，木制线条

轿壁：木饰面板，木制线条，黑色镜面不锈钢

扶手：木质扶手

地板：PVC(可选大理石)

Ceiling: Wood, wood molding

Car wall: Wood, wood molding, sts black mirror,

antique lighting

Handrail: Wood

Floor: PVC (Optional marble)



注：图片系电脑绘制，可能与实际图有不同，以实物为准。
Note: pictures have been drawn by computer. It might be slightly different from actual colors. Please take real product as criterion.

注：图片系电脑绘制，可能与实际图有不同，以实物为准。
Note: pictures have been drawn by computer. It might be slightly different from actual colors. Please take real product as criterion.

电梯装潢 厅门系列

Elevator decoration Landing door series



FJM-M02

镜面、蚀刻、发纹
Mirror Finish, Etching Finish,
Hairline Finish

FJM-M03

喷金、蚀刻、和纹
Spray gold, Etching Finish,
Vibration Finish

FJM-M04

镜面、蚀刻、发纹
Mirror etched stainless steel
and hairline stainless steel

FJM-M05

镜面、蚀刻、发纹
Mirror etched stainless steel
and hairline stainless steel



FJM-M06

镜面、蚀刻、钛金
Mirror Finish, Etching Finish,
Ti-plated finish

FJM-M07

钛金、镜面、蚀刻
Ti-Plated finish, mirror finish,
etching finish

FJM-M08

镜面、蚀刻、玫瑰金
Mirror Finish, Etching Finish,
Rose Gold

FJM-M09

有框玻璃门(镜面、发纹)
A frame glass door
(Mirror Finish, Hairline Finish)

注：图片系电脑绘制，可能与实际图有不同，以实物为准。
Note: pictures have been drawn by computer. It might be slightly
different from actual colors. Please take real product as criterion.

手动门系列

Manual door series



FJM-D01

木纹饰面
Wood finishes

FJM-D02

木纹色边框、中间透明玻璃
Wood grain color border,
transparent glass in the middle

FJM-D03

黑色边框、中间夹丝玻璃
Black frame, wire glass in the
middle

FJM-D04

木纹色边框、中间密度板、
磨砂玻璃
Wood grain frame, density board
in the middle, ground glass

折叠门

Folding door



FJM-F01

透明有机玻璃轿厢折叠门
颜色：红胡桃
Transparent organic glass door
Color: red walnut

FJM-F02

透明有机玻璃轿厢折叠门
颜色：白色
Transparent organic glass door
Color: white

FJM-F03

透明有机玻璃轿厢折叠门
颜色：金色
Transparent organic glass door
Color: Gold

注：图片系电脑绘制，可能与实际图有不同，以实物为准。
Note: pictures have been drawn by computer. It might be slightly
different from actual colors. Please take real product as criterion.

电梯装潢 吊顶系列

Elevator decoration Ceiling series



FJM-DH2

镜面不锈钢框架, 亚克力, LED灯
Mirror stainless steel, acrylic, LED light



FJM-DH1

发纹不锈钢, LED灯
Hairline stainless steel, LED lamp



FJM-DH3

镜面不锈钢, 亚克力灯饰
Mirror stainless steel, acrylic lighting



FJM-DH4

镜面不锈钢框架, 亚克力透光板
Mirror stainless steel, Acrylic transparent board



FJM-DH5

镜面不锈钢框架, LED灯
Mirror stainless steel, LED light



FJM-DH6

发纹不锈钢框架, 亚克力灯饰
Hair grain stainless steel frame, acrylic lighting

注: 图片系电脑绘制, 可能与实际图有不同, 以实物为准。
Note: pictures have been drawn by computer. It might be slightly different from actual colors. Please take real product as criterion.

电梯装潢 操纵箱系列

Elevator decoration Operation panel series



FCP02

(选配 Optional)



FLB02



FCP11

(选配 Optional)



FLB11

一体式无底盒召唤盒
One-piece bottom box calling board



FLB-E



FLB-F

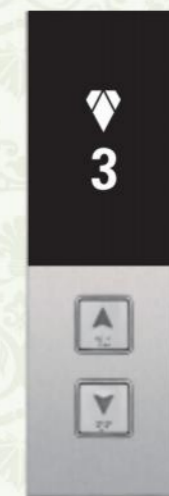

FLB-G



FLB-H



FCP12



FCP12-B

注: 图片系电脑绘制, 可能与实际图有不同, 以实物为准。
Note: pictures have been drawn by computer. It might be slightly different from actual colors. Please take real product as criterion.

扶手系列
Handrail series



FS01



FS04



FS02



FS05



FS03



FS06

可选显示器
Optional display



6.4"STN



6.4"BND



7/10.4"TFT

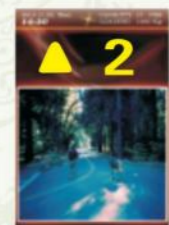

7/10.4"TFT

可选按钮
Optional button



BA215



BA161



BA545

电梯装潢

Elevator decoration

地板 Floor



HDB01

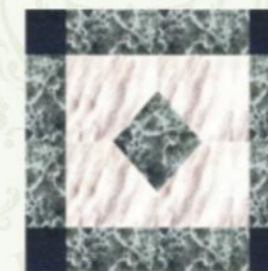

HDB02



HDB03



HDB04

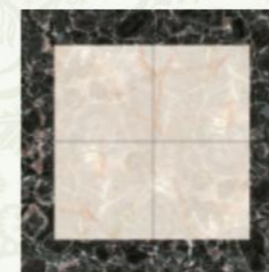

HDB05



HDB06



HDB07



HDB08



HDB09



HDB10



HDB11



HDB12



主要功能配置

The main function configuration

Standard functions

标准功能

电梯变频驱动 VVVF drive	精确调整电动机转速, 令电梯起动、运行、停止时的速度曲线平稳、圆滑, 获得良好的舒适感。 Motor rotating speed can be precisely adjusted to get smooth speed curve in elevator start, travel and stop and gain the sound comfort.
门机变频驱动 VVVF door operator	精确调整电动机转速, 使门机的开启、关闭更轻柔灵敏。 Motor rotating speed can be precisely adjusted to get the more gentle and sensitive door machine start/stop.
自动不停站通过 Automatic pass without stop	当轿内挤满乘客或负载接近预定值, 为保持最大运行效率, 该轿厢将自动越过召唤层站。 When the car is crowded with the passengers or the load is close to preset value, the car will automatically pass the calling landing in order to keep maximum travel efficiency.
本层重开门 Reopen with hall call	关门途中, 可以按本层站召唤按钮使门重新开启。 In the door shutting process, press reopen with hall call button can restart the door.
即时关门 Express door closing	电梯停站开门到位时, 按下关门按钮, 门立即被关闭。 When the elevator stops and opens the door, press door-shut button, the door will be closed immediately.
停梯开门 Car stops and door open	电梯减速平层, 直到完全停稳后才开门。 The elevator decelerates and levels, the door only opens after the elevator comes to a complete stop.
光幕保护 Photo cell protection	门开启和关闭期间, 用覆盖整个门高度的红外光幕探测乘客和物体的门保护装置。 In the door open and shut period, infrared light that covers the whole door height is used to probe the door protection device of both the passengers and objects.
超载停梯 Overload holding stop	轿厢超载时, 鸣响蜂鸣器并停止于该层站。 When the car is overload, the buzzer rings and stops the elevator in the same floor.
检修操作 Inspection operation	当进入检修状态时, 轿厢以低速点动运行。 When the elevator enters into inspection operation, the car travels at inching running.
故障自诊断 Fault self-diagnosis	控制器可记录最新的62个故障, 以便快速排除故障, 迅速恢复电梯运行。 The controller can record 62 latest troubles so as to quickly remove the trouble and restore the elevator operation.
电梯门重复开关 Repeated door closing	有时因阻碍或干扰, 电梯门未能关闭, 电梯门会重复打开或关闭, 直到杂物被清除。 If the elevator can not close the door due to certain obstacle or interference, the elevator will reopen or re-shut the door until sundries are eliminated.
上下越层及上下极限保护装置 Up/down over-run and final limit protection	该装置可有效地防止当电梯万一发生失控时的冲顶或撞底现象, 使电梯更安全可靠。 The device can effectively prevent from the elevator's surging to the top or knocking the bottom when it is out of control. It results in more safe and reliable elevator travel.
下行超速保护装置 Down over-speed protection device	当电梯下降运行的速度超过额定速度的1.3倍时, 该装置自动切断控制电源, 使电机停止运转, 安全钳动作, 强制电梯停止运行, 保证安全。 When the elevator downs 1.3 times higher than the rated speed, this device will automatically cut off control mains, stop the motor running, safety tongs act to force the elevator stop in order to ensure the safety.
轿内及层站微动指令按钮 Micro-touch button for car call and hall call	轿内操纵箱指令按钮及层站召唤按钮采用新型微动型按钮 Novel micro-touch button is used for operation panel command button in the car and landing calling button.
轿内层楼、方向指示 Floor and direction indicator inside car	轿内显示电梯所在层楼及当前运行方向。 The car shows the elevator floor location and current travel direction.
层站层楼、方向指示 Floor and direction indicator in hall	层站显示电梯所在层楼及当前运行方向。 The landing shows the elevator floor locating and current travel direction.
轿厢风扇/照明自动开关 Car ventilation, light automatic shut off	在规定的时间内没有召唤或指令信号, 轿厢内的风扇和照明会自动关闭, 以节能。 If there is no calling or command signal within the stipulated time, the car fan and lighting will be automatically closed in order to save the energy.
远程关闭 Remote shut-off	通过钥匙开关, 电梯可以被召唤到基站(服务完成后), 并自动退出服务。 The elevator can be called to main landing (after finishing the service) through the key switch and automatically exists the service.

Optional functions

选配功能

停电应急平层 Uninterrupted power supply (OPS)	正常电源断电时, 充电式电池提供电梯电源, 电梯驶往最近层站。 In normal power failure, the chargeable battery supplies the elevator power. The elevator drives to the nearest landing.
语音报站 Voice system	在正常运行到站的情况下, 利用语音装置告知乘客有关信息。 When the elevator normally arrives, voice announcer informs the passengers about the relevant information.
轿内摄像功能 Camera function in the car	摄像头装于轿厢内监视轿内情况。 The camera is installed in the car to monitor the car conditions.

可选钢板材质

Optional steel plate material

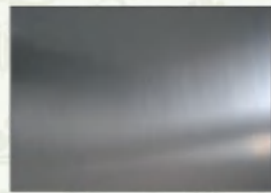

镜面不锈钢
Mirror stainless steel



古铜
Bronze



玫瑰金
Rose gold



钛金不锈钢
Titanium gold stainless steel

木纹材质

Wood material



MW01



MW02

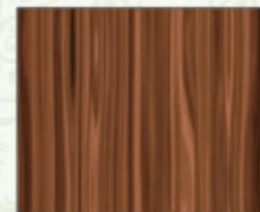

MW03



MW04

色标系列

Color standard series



象牙黄
Ivory yellow

SK01

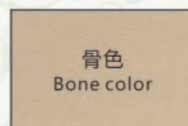

骨色
Bone color

SK02

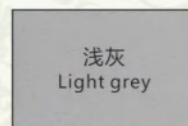

浅灰
Light grey

SK03



浅绿
Light green

SK04



海蓝
Blue

SK05



亚光黑
Matte black

SK06

曳引式别墅电梯土建图（钢带）

Traction type villa elevator construction sketch (Steel belt)

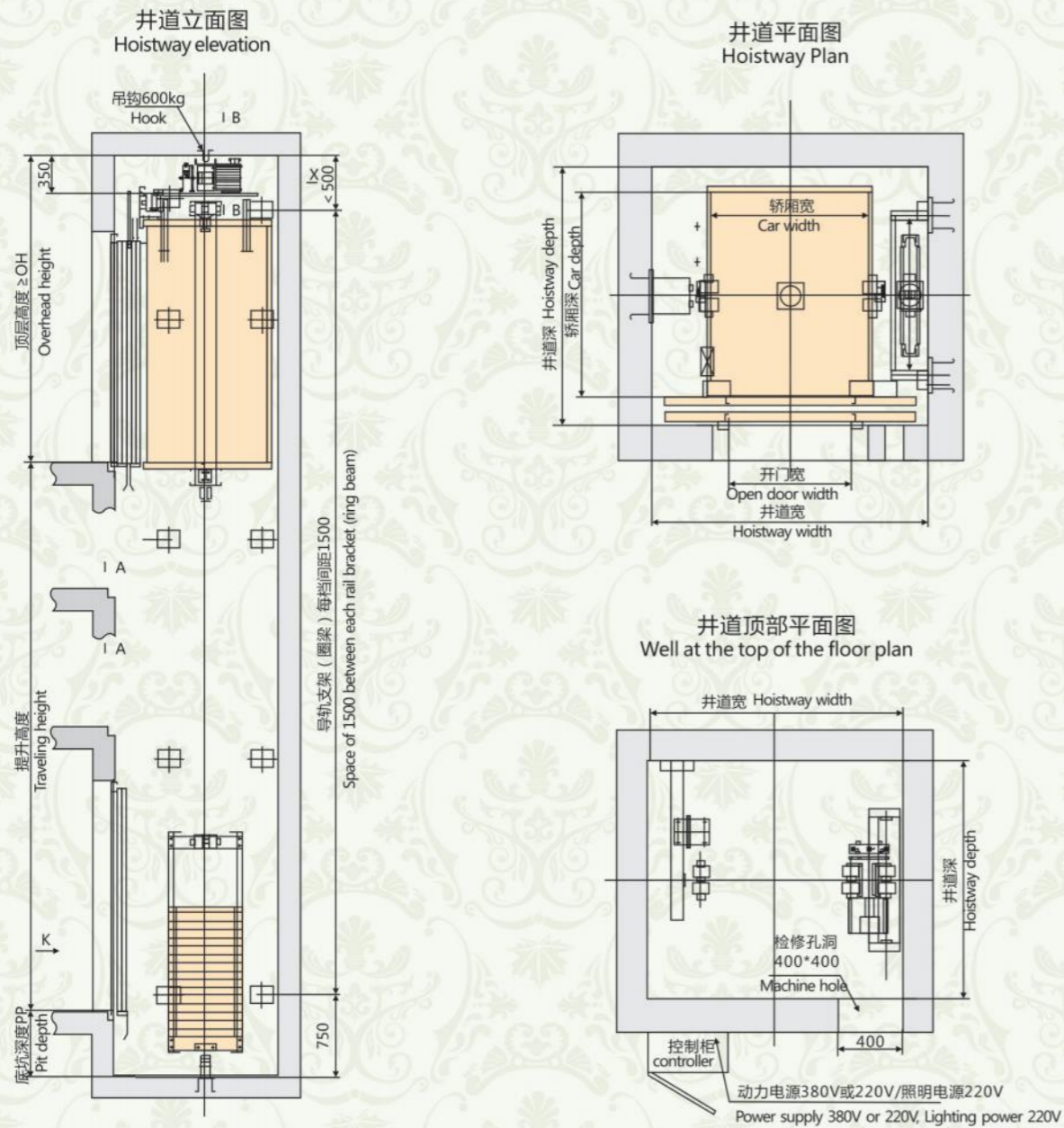

曳引别墅电梯型号及技术参数表

Traction villa elevator model and technical parameter table

型号 Model	载乘人数 (人) Persons	额定载重 (kg) Rated capacity	额定速度 (m/s) Rated speed	额定功率 (KW) Rated power	轿厢净尺寸 (m/m) Net size of car		净门距 (m/m) Net width of door D.W × D.H			井道尺寸 (m/m) Hoistway size		
					宽 × 深 C.W × C.D	中分两扇门 2P center opening	宽 × 深 H.W × H.D	顶层高 OH	底坑深 PP			
FJH	4	320	0.4	0.96	900 × 1100	700 × 2000	1550 × 1400	3000	400			
	5	400	0.4	1.1	1000 × 1200	750 × 2000	1650 × 1500	3000	400			

注：上述尺寸供设计参考，具体尺寸以合同约定时提供的土建图为准。
Note: Only for reference, final manufacture please follow contract.

曳引式别墅电梯土建图（钢丝绳）

Traction type villa elevator construction sketch (Steel wire rope)

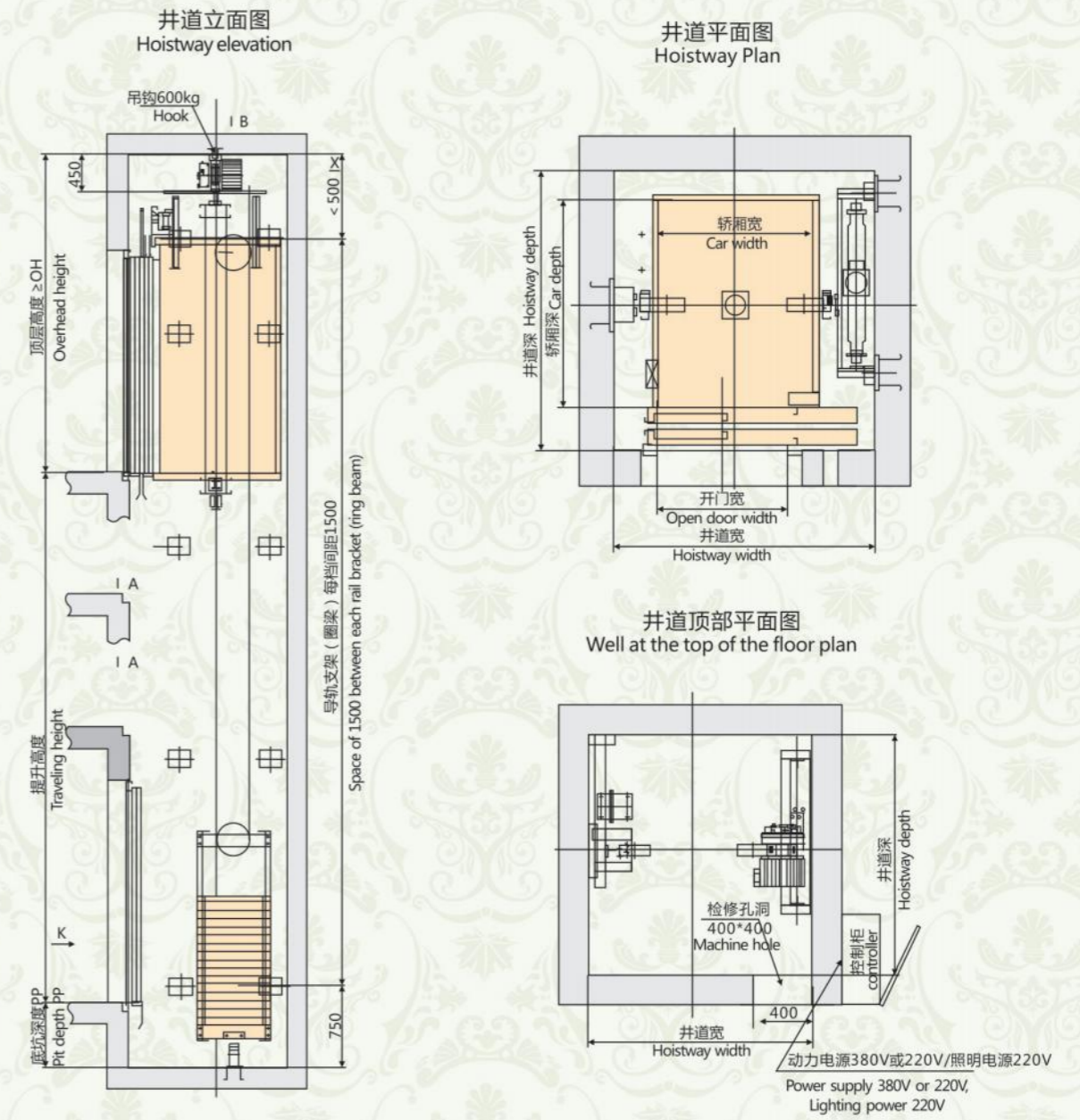

曳引别墅电梯型号及技术参数表

Traction villa elevator model and technical parameter table

型号 Model	载乘人数 (人) Persons	额定载重 (kg) Rated capacity	额定速度 (m/s) Rated speed	额定功率 (KW) Rated power	轿厢净尺寸 (m/m) Net size of car		净门距 (m/m) Net width of door D.W × D.H		井道尺寸 (m/m) Hoistway size		
					宽 × 深 C.W × C.D	中分两扇门 2P center opening	宽 × 深 H.W × H.D	顶层高 OH	底坑深 PP		
FJH	3	260	0.4	0.96	800 × 1000	700 × 2000	1400 × 1400	3200	500		
	4	320	0.4	0.96	900 × 1100	750 × 2000	1500 × 1500	3200	500		
	5	400	0.4	1.1	1000 × 1200	800 × 2000	1600 × 1600	3200	500		

注：上述尺寸供设计参考，具体尺寸以合同约定时提供的土建图为准。
Note: Only for reference, final manufacture please follow contract.

强制式别墅电梯土建图

Forcibly driven villa elevator construction sketch

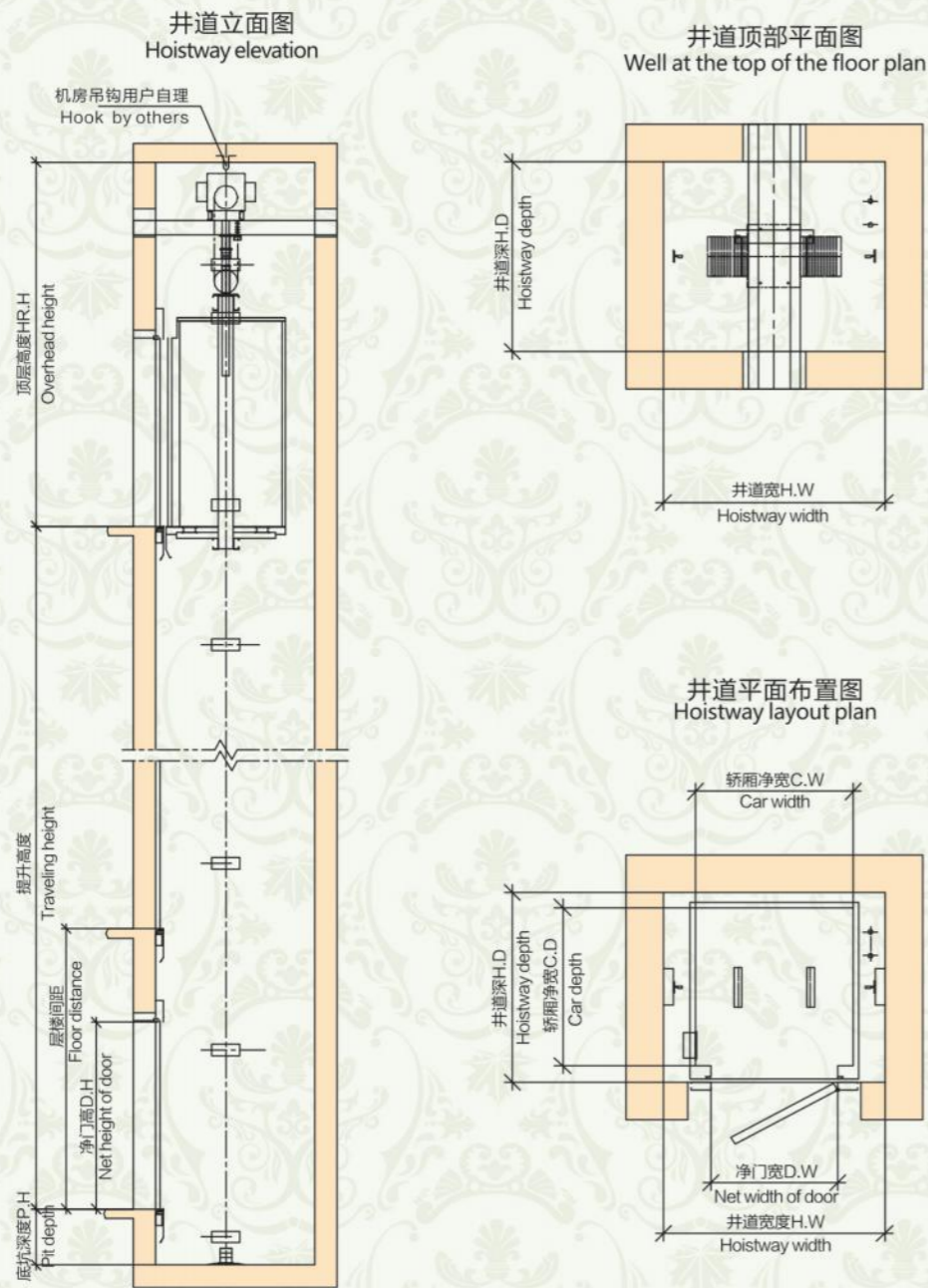

强制别墅电梯型号及技术参数表

Forcibly driven villa elevator model and technical parameter table

型号 Model	额定载重 (kg/人) Rated capacity	速度 (m/s) Speed	轿厢净尺寸 (宽x深x高) Net size of car	净门尺寸 (宽x高) Net door size	井道净尺寸 (宽x深) Net size hoistway	底坑深度 Pit depth	顶层高度 Overhead height	电源规格 Power supply	开门方式 Opening mode
FJH	260(3)	0.3	800x800x2200	700x2000	1200x1000	400	3900	单相220V或 三相380V Single-phase 220V or three -phase 380V	手拉门 manually operated door
	320(4)		900x1000x2200	800x2000	1300x1200				
	400(5)		1000x1100x2200	800x2000	1400x1300				

注：上述尺寸供设计参考，具体尺寸以合同约定时提供的土建图为准。
Note: Only for reference, final manufacture please follow contract.



富士美采用先进传感技术采集电梯实时运行数据，通过微处理器进行数据分析、建模和建立故障专家库，采用GPRS+GSM的通讯模式将数据传输到监视中心，实现电梯故障预警和报警、困人救援、日常管理、质量评估、隐患防范、风险评估、对标系统、节能技术开展等功能的综合性电梯管理平台。

FUJIM adopts advanced sensor technology to collect real-time operation data of elevator, makes data analysis, modeling through micro processor, adopts GPRS+GSM communication pattern to transmit data to monitoring center, being comprehensive elevator management platform realizing elevator malfunction fault alarm, rescue, daily management, quality evaluation, risk prevention, risk evaluation, benchmarking system and energy technology.

